

# 513 Fast-Acting Miniature Fuse

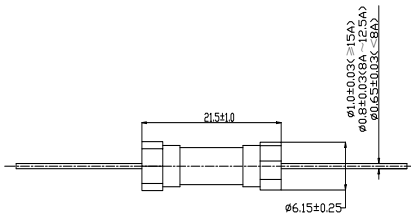

Dimensions (unit: mm)

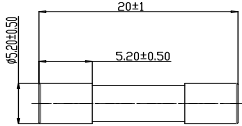

## Main Characteristics

Axial miniature fuse; Fast-Acting

## Standard

UL248-14

## Materials

Tube: Ceramic Tube

End Caps: Silver plated copper

## Operating Temperature

-55°C to +125°C

## Storage Conditions

+10°C to +60°C

Relative humidity: ≤75% yearly average

Without dew, maximum 30 days at 95%

## Vibration Resistance

24 cycles at 15 min. each (60068-6)

10-60Hz at 0.75mm amplitude

60-2000Hz at 10g acceleration

## Soldering Parameters

260°C. ≤5 sec (Wave Soldering)

350°C. ≤3 sec (Hand Soldering)

## Soldering Peak:

260°C. 10 sec. (IEC 60068-20)

Average Time Current(I-T Curves)

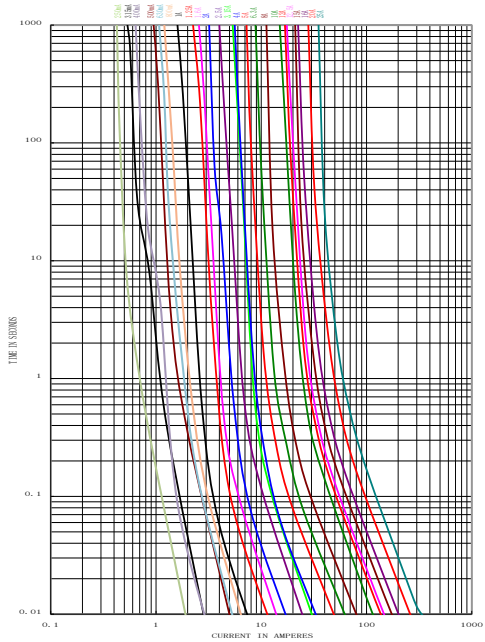

Time vs Current Characteristics: UL 248-14

Rated Current	100%	210%	275%	400%	1000%
0.2A~20A	>1h	<30min	40ms~20s	10ms~1s	≤30ms



Electrical Characteristics at 25°C

Amp Code	Rated Current	Rated Voltage	Nominal Melting I <sup>2</sup> t (A <sup>2</sup> sec)	Typical cold Resistance (mΩ)	Breaking Capacity	Approvals
						cURus
0250	250mA	300V AC/DC	0.019	11500	1500A@300VAC 1000A@300VDC	●
0315	315mA		0.062	7500		●
0400	400mA		0.058	4650		●
0500	500mA		0.247	1080		●
0630	630mA		0.221	787		●
0800	800mA		0.325	607		●
1100	1.00A		0.440	281		●
1125	1.25A		1.230	164		●
1160	1.60A		1.750	142		●
1200	2.00A		2.680	101		●
1250	2.50A		5.930	67.4		●
1315	3.15A		8.930	38.0		●
1400	4.00A		10.40	34.5		●
1500	5.00A		23.70	23.2		●
1630	6.30A		38.50	18.4		●
1800	8.00A		64.00	14.0		●
2100	10.00A		138.0	9.20		●
2120	12.00A		192.0	7.70		●
2125	12.50A		225.0	7.20		●
2150	15.00A		312.0	6.10	●	
2160	16.00A		434.0	5.40	●	
2200	20.00A		732.0	4.10	750A@300VAC 1000A@300VDC	●
2250	25.00A		1106	3.35		●

- Notes:** (1) Permissible continuous operating current is ≤100% at ambient temperature of 23°C (73.4°F)  
 (2) Typical pre-arcing I<sup>2</sup>t are measured at 10In current.

## Ordering Information

Series	Amp Code	Supplementary Code	Qty
513			