

474 Brick Fuse

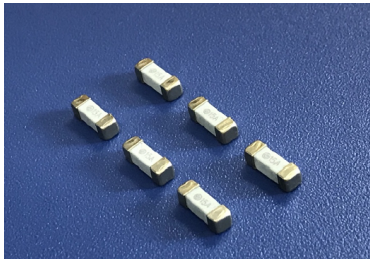

Main Characteristics

Brick fuse; Fast-acting(F)

Standard

UL248-14

Materials

Body: Ceramic
End Caps: Copper plated with gold

Operating Temperature

-55°C to +125°C

Stock Temperature

+10°C to +60°C
Relative humidity: ≤75% yearly average
Without dew, maximum 30 days at 95%

Vibration Resistance

24 cycles at 15 min. each (60068-6)
10-60Hz at 0.75mm amplitude
60-2000Hz at 10g acceleration

Soldering Parameters

260°C. ≤10 sec (Wave Soldering)
300°C. ≤2 sec (Hand Soldering)
Soldering Peak:
260°C. 10 sec.
280°C. 5 sec. (IEC 60068-20)

Average Time Current(I-T Curves)

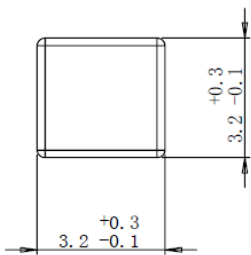
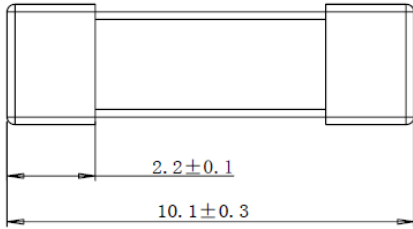
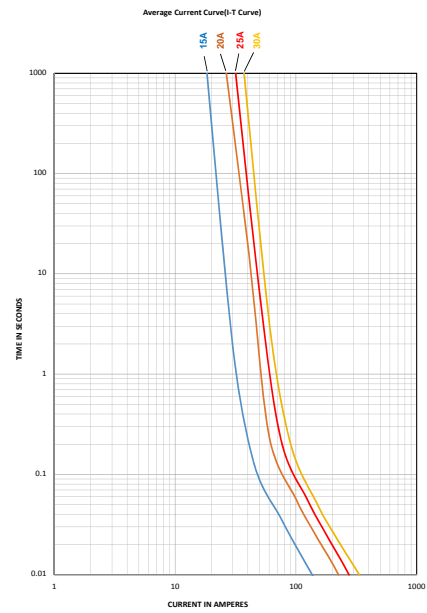

Dimensions(unit:mm)

Time vs Current Characteristics: UL248-14		
Rated Current	100%	200%
15~30A	>4H	<60s



Electrical Characteristics at 25°C								
Amp Code	Rated Current	Rated Voltage	Max. Voltage Drop (mV)	Breaking Capacity	Typical Melting I ² t(A ² sec)	Typical Cold Resistance (mΩ)	Approval	Marking
							cURus	
2150	15.00A	32V DC 72V DC 125V AC	80	1000A@32V DC 500A@72V DC 150A@125V AC 100A@250V AC*	190	3.37	•	⚡ 15A
2200	20.00A		55		506	2.07	•	⚡ 20A
2250	25.00A		50		756	1.78	•	⚡ 25A
2300	30.00A		75		1122	1.53	•	⚡ 30A

- Note:** (1) Permissible continuous operating current is ≤100% at ambient temperature of 23°C (73.4°F)
 (2) The current values used for calculating I²t should be within the standard range of 8ms ~ 10ms.
 (3) * Breaking Capacity of 100A @250VAC is tested by internal, certification is pending.

Ordering Information

Series	Amp Code	Supplementary Code	Qty
474			



Sales Contact
sis01@beterfuse.com

Technical Support
Kenny@betterfuse.com

National High-tech Enterprise
SC 32C National Technical Committee Member of China
Intertek ISO 9001 Certified Company
Intertek ISO 14001 Certified Company
Intertek QC 080000 Certified Company
NQA IATF 16949 Certified Company

国家高新技术企业
SC 32C 国内专家组成员单位
ISO 9001 认证企业
ISO 14001 认证企业
QC 080000 认证企业
IATF 16949 认证体系